

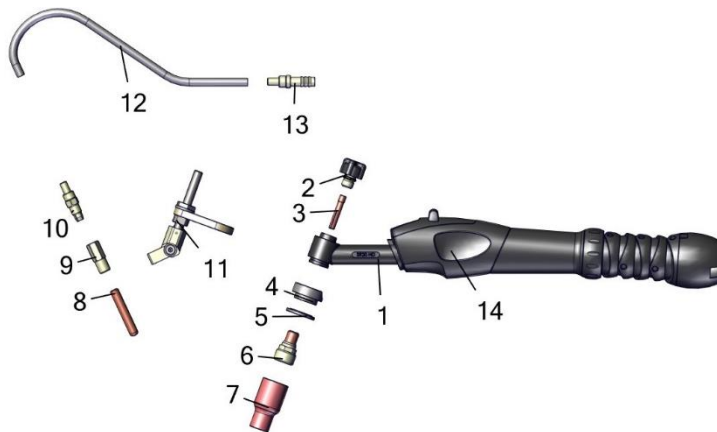

## Hot and Cold Wire Welding Torch SR20 HD, water cooled

Technical data according to EN 60 974-7

Rating: 220A DC  
170A AC  
Duty cycle: @ 100%  
Tungsten electrodes: Ø0,5 – 3,2mm



### Part Number for complete Welding Torch

Part. No.	4m
SR 20 ARgo-handle Up/Down, hot wire with Euro-connection, BSB (SK35), gas 1/4", without plug	120489205



## Spare Parts List

Pos.	Part. No.	Description	Pos.	Part. No.	Description
1	12001051	Torch Body SR 20 Hot Wire	7	53N58L	Ceramic Nozzle # 4 for Gas Lens 35 mm long
2	1090212	Back Cap, short		53N59L	Ceramic Nozzle # 5 for Gas Lens 35 mm long
	1090211	Back Cap, medium		53N60L	Ceramic Nozzle # 6 for Gas Lens 35 mm long
	1090210	Back Cap, long		53N61L	Ceramic Nozzle # 7 for Gas Lens 35 mm long
3	1200510	Collet 1.0		53N61SL	Ceramic Nozzle # 8 for Gas Lens 35 mm long
	1200516	Collet 1.6	8	105031047	Hot Wire Tip 0.8
	1200524	Collet 2.4		105031048	Hot Wire Tip 1.0
	1200532	Collet 3.2		105031049	Hot Wire Tip 1.2
4	105030041	Insulator		105031050	Hot Wire Tip 1.4
5	105030042	Insulatorring	9	105031102	Clamping Element
6	1202310	Collet Body Gas Lens 1.0	10	105031101	Clamping Screw
	1202316	Collet Body Gas Lens 1.6	11	105031100	Hot Wire Mounting, cpl.
	1202324	Collet Body Gas Lens 2.4	12	105031110	Protection Tube
	1202332	Collet Body Gas Lens 3.2	13	105031112	Connector
			14	11727603	Handle cpl. Argo-TIG Up-Down including PCB