



## Manual Welding Torch SB 600G, air cooled

Technical data according to EN 60 974-7

Rating:

CO <sub>2</sub> :	450A
Mixed gas M21:	380A
Duty cycle:	@60%
Wire-Ø:	1,2 – 2,4mm

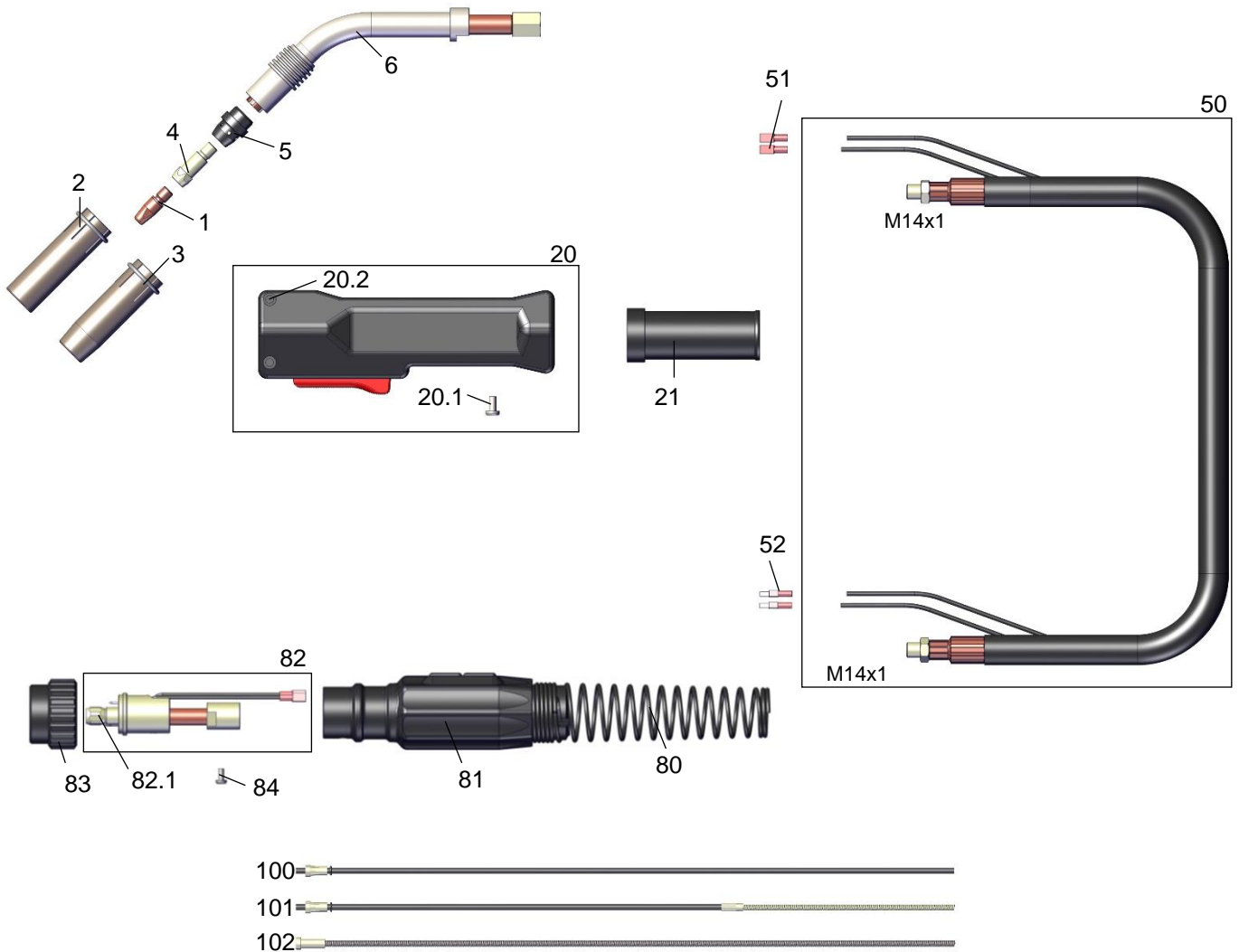
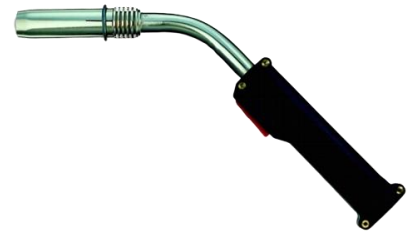

### Part Number for complete Welding Torch

Standard configuration tip Ø 1,2mm

	3m	4m	5m
SB 600G cpl. AR3 -handle and Euro-connection (Steel liner 2,5x4,5mm)	2603001	2604001	2605001



## Spare Part List

Pos.	Part No.	Description	Pos.	Part No.	Description
1	24106xx	Contact Tip M8x30, $\varnothing$ in mm / ECu <sup>1</sup> (PU=10)	50	3006530	Coaxial Cable 65 mm <sup>2</sup> , 3 m
	24176xx	Contact Tip M8x30, $\varnothing$ in mm / CuCrZr (PU=10)		3006540	Coaxial Cable 65 mm <sup>2</sup> , 4 m
	24166xx	Contact Tip M8x30, $\varnothing$ in mm / for Alu (PU=10)		3006550	Coaxial Cable 65 mm <sup>2</sup> , 5 m
	26076xx	Contact Tip M10x35, $\varnothing$ in mm / CuCrZr (PU=10)	51	2155302	Female Electrical Connector, insulated (PU=20)
	<i>Contact Tips available in <math>\varnothing</math> 0.8/0.9/1.0/1.2/1.6/2.0//2.4 mm</i>		52	2155200	Male Electrical Connector, insulated (PU=20)
	<i>Please insert wire diameter at <b>xx</b>.</i>				
	<i>Example: <math>\varnothing</math> 1,2 mm is: 12; Part No.: = 2410612</i>				
2	2600408	Tip adapter M8 <sup>1</sup> (PU=5)	80	2411611	Cable Support Spring
	2600410	Tip adapter M10 (PU=5)	81	2411600S1	Gun Plug Housing, without Nut
3	2600700	Gas diffusor <sup>1</sup> (PU=5)	82	2401505	Central plug air cooled, spring loaded pins
4	2600801	Gas nozzle, cylin. NW23 L=90mm (PU =5)	82.2	2151501	Liner Positioner Nut
5	2600802	Gas nozzle, con. NW19,5 L=90mm <sup>1</sup> (PU=5)	83	2151700	Plug Nut
6	2600100	Torch neck SB 600G for Ergo-handle	84	0040601	Screw (1) (PU=20)
20	2401000	Handle AR 3 black, cpl.	100	34120X0	PTFE-Liner 2,0x4,0mm / X <sub>m</sub> red
20.1	0041601	Screw M4x16 (4) (VE=20)		34727X0	PTFE-Liner 2,7x4,7mm / X <sub>m</sub> yellow
20.2	0041012	Handle nut (4) (VE=20)		35120X0	Carbon-PTFE-Liner 2,0x4,0mm / X <sub>m</sub> black
21	2401200	Cable support handle		35127X0	Carbon-PTFE-Liner 2,7x4,7mm / X <sub>m</sub> black
				35220X0	PA-Liner 2,0x4,0mm / X <sub>m</sub> anthracite
				35327X0	PA-Liner 2,7x4,7mm / X <sub>m</sub> anthracite
			101	34120X0K	Combi-PTFE-Liner 2,0x4,0mm / X <sub>m</sub> red
				34727X0K	Combi-PTFE-Liner 2,7x4,7mm / X <sub>m</sub> yellow
				35120X0K	Combi- Carbon-PTFE- Liner 2,0x4,0mm / X <sub>m</sub> black
				35127X0K	Combi- Carbon-PTFE- Liner 2,7x4,7mm / X <sub>m</sub> black
				35320X0K	Combi-PA-Liner 2,0x4,0mm / X <sub>m</sub> anthracite
				35327X0K	Combi-PA-Liner 2,7x4,7mm / X <sub>m</sub> anthracite
			102	34420X1	Steel Liner 2,0x4,0mm / X <sub>m</sub> coated red
				34425X1	Steel Liner 2,5x4,0mm / X <sub>m</sub> <sup>1</sup> coated yellow
				3493530	Steel Liner 3,5 x 4,9 mm / 3 m
				3493540	Steel Liner 3,5 x 4,9 mm / 4 m
				3493550	Steel Liner 3,5 x 4,9 mm / 5 m
				<i>Liners available in 3m/4m/5m. Please insert length at <b>X</b>.</i>	
				<i>Example: Steel Liner 4m = 3442541</i>	

<sup>1</sup> Included in standard configuration