



Manual Welding Torch SB 360 GD, air cooled, turnable neck

Technical Data according to EN 60 974-7

Rating:

CO₂: 300A

Mixed gas M21: 270A

Duty cycle: @60%

Wire-Ø: 0,8 – 1,2mm

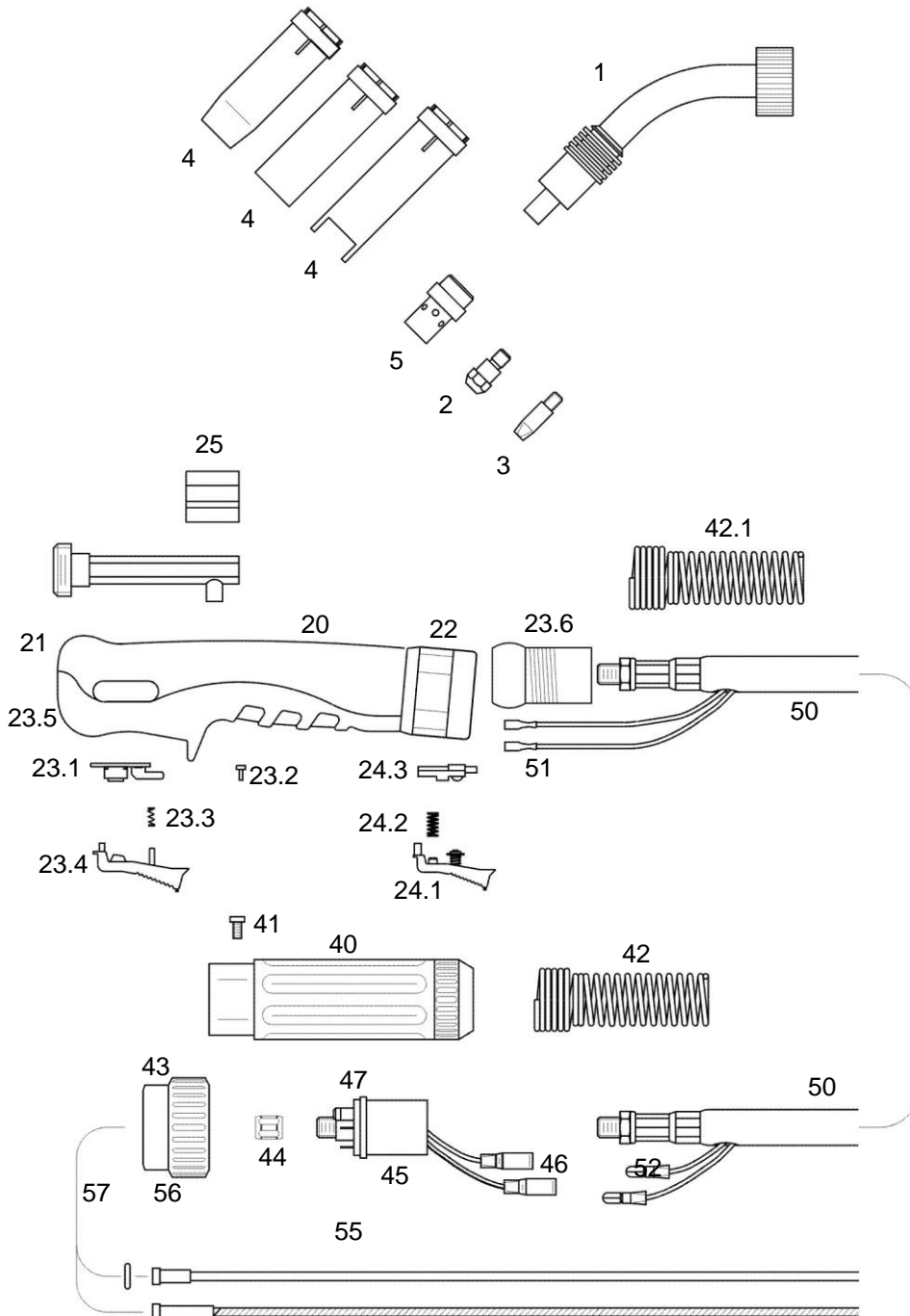



Part Number for complete Welding Torch

Part. No.	3m	4m	5m
Ergo-Handle	2373030	2374030	2375030
Ergo Bladeswitch Handle	2373050	2374050	2375050

Spare Part List

Pos.	Part. No.	Description	Pos.	Part. No.	Description
1	2370100	torch Neck	23.4	2111106	Trigger
			23.5	2101101	Screw
2	2360406	Tip Adapter M6, short	23.6	2111175	Swivel
	2360416	Tip Adapter M6, long	24.1	2111151	Trigger, Ergo-Blade-Switch
	2360408	Tip Adapter M8, short	24.2	2111152	Spring, Ergo-Blade-Switch
	2360418	Tip Adapter M8, long	24.3	2111153	Contact Holder, Ergo-Blade-Switch
			25	2150307	Connection Body for seperat gas
3	22506xx	Contact Tip M 6 x 28, ø in mm ECU	40	2251601	Gun Plug Housing, two pieces
	22576xx	Contact Tip M 6 x 28, ø in mm CuCrZr	41	0040601	Screw
	22566xx	Contact Tip M 6 x 28, ø in mm für / for Alu	42	2151201	Cable Support Spring
		<i>Tips available in ø 0.8/0.9/1.0/1.2/1.4/1.6 mm</i>	42.1	2111191	Cable Support Spring
		<i>Please insert wire diameter at xx. Example:</i>	43	2151700	Plug Nut
		<i>ø 0,8 mm is: 08; Part.-No.: = 2250608</i>	44	2151501	Liner Positioner Nut
4	2360801	Gas Nozzle, cylindrical	45	2151500	Gun Plug Body, air cooled
	2360802	Gas Nozzle, conical		2151505	Gun Plug Body with Spring Loaded Pins
	2360803	Gas Nozzle, tapered	46	2155100	Female Electrical Connector, insulated
	2360805	Spot Welding Gas Nozzle	47	0041000	O - Ring
5	2360702	Gas Diffuser, white	50	3005030	Coaxial Cable 50 mm ² , 3 m
	2360700	Gas Diffuser, black		3005040	Coaxial Cable 50 mm ² , 4 m
10	2370101	Torch Body for turnable torch neck, Ergo-Handle		3005050	Coaxial Cable 50 mm ² , 5 m
20	2111100	Ergo-Handle cpl.	51	2415304	Female Electrical Connector 2,8 x 0,8, bare
21	2111101	Ergo-Handle Shells with Nut	52	2155200	Male Electrical Connector, insulated
22	2111123	Nut	55	3441530	Steel Liner 1,5 x 4,0 mm / 3 m
23.1	2111103	PC Board		3441540	Steel Liner 1,5 x 4,0 mm / 4 m
23.2	2111104	Screw for PCB		3441550	Steel Liner 1,5 x 4,0 mm / 5 m
23.3	2111105	Spring			



Pos.	Part. No.	Description	Pos.	Part. No.	Description
55	3411530	PTFE- Liner 1,5 x 4,0 mm / 3 m			
	3411540	PTFE- Liner 1,5 x 4,0 mm / 4 m			
	3411550	PTFE- Liner 1,5 x 4,0 mm / 5 m			
	3442030	Steel Liner 2,0 x 4,0 mm / 3 m			
	3442040	Steel Liner 2,0 x 4,0 mm / 4 m			
	3442050	Steel Liner 2,0 x 4,0 mm / 5 m			
	3412030	PTFE- Liner 2,0 x 4,0 mm / 3 m			
	3412040	PTFE- Liner 2,0 x 4,0 mm / 4 m			
	3412050	PTFE- Liner 2,0 x 4,0 mm / 5 m			
56	2155640	Collet for coated Liner 4.0			
	2155740	Collet for Teflon Liner 4.0			
57	0031500	O - Ring			