



Machine Torch SB 360G AUT, air cooled

Technical Data according to EN 60 974-7

Rating:

CO₂: 320A
Mixed gas M21: 290A
Duty cycle: @60%
Wire-Ø: 0,8 – 1,2mm

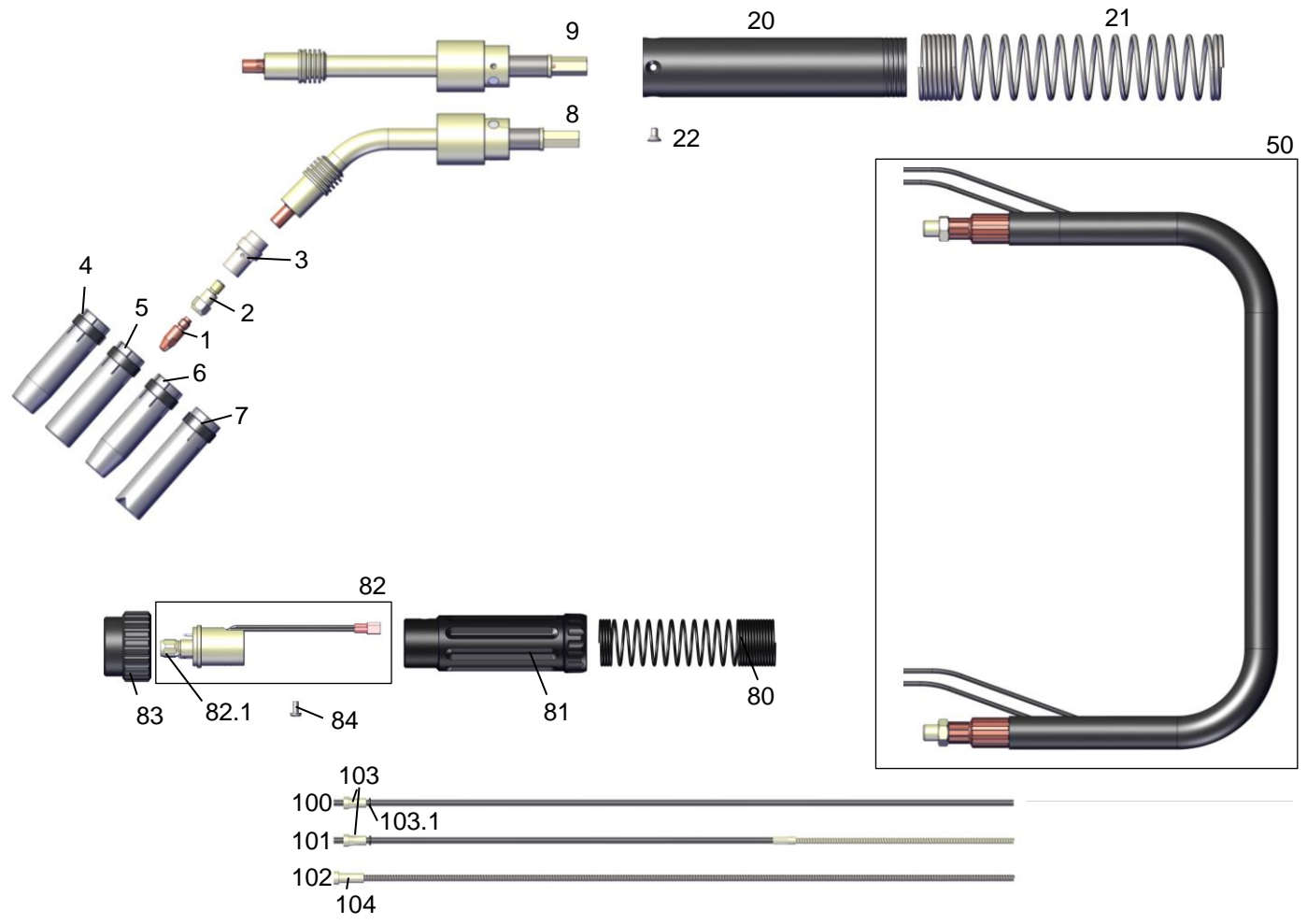

Part Number for complete Welding Torch

Standard equipment for Ø 1,2mm

Part. No.	3m	4m	5m
SB 360G AUT – 180° cpl. with Euro connection and equipped steel liner 2,0x4,0mm	2363009	2364009	2365009
SB 360G AUT – 45° cpl. with Euro connection and equipped steel liner 2,0x4,0mm	2363019	2364019	2365019

	dimensions	X	Y
	180° (straight)	185 mm	-
	45° bent	145 mm	75 mm



Spare Part List

Pos.	Part No.	Description	Pos.	Part No.	Description
1	22506xx	Contact Tip M6x28, \varnothing in mm / ECu ¹ (PU=10)	50	3005030	Coaxial Cable 50mm ² , 3m
	22576xx	Contact Tip M6x28, \varnothing in mm / CuCrZr (PU =10)		3005040	Coaxial Cable 50mm ² , 4m
	22566xx	Contact Tip M6x28, \varnothing in mm / für Alu (PU =10)		3005050	Coaxial Cable 50mm ² , 5m
	24106xx	Contact Tip M8x30, \varnothing in mm / ECu (PU =10)			
	24176xx	Contact Tip M8x30, \varnothing in mm / CuCrZr (PU =10)	80	2401201	Cable Support Spring
	24166xx	Contact Tip M8x30, \varnothing in mm / für Alu (PU =10)	81	2251601	Gun Plug Housing Nut
	<i>Contact Tips available in \varnothing 0.8/0.9/1.0/1.2 mm</i>		82	2151505	Gun Plug Body with Spring Loaded Pins
	<i>Please insert wire diameter at xx.</i>		82.1	2151501	Liner Positioner Nut
	<i>Example: \varnothing 1.2 mm is: 12; Part No.: = 2416612</i>				
2	2360406	Tip Adapter M6, short ¹ (PU =10)	83	2151700	Plug Nut
	2360416	Tip Adapter M6, long (PU =10)	84	0040601	Screw (1) (PU =10)
	2360408	Tip Adapter M8, short (PU =10)			
	2360418	Tip Adapter M8, long (PU =10)			
3	2410702	Gas diffusor, white ¹ (PU =10)			
	2410700	Gas diffusor, black (PU =10)			
4	2360801	Gas Nozzle, cylin. NW19 L=84mm (PU =10)			
5	2360802	Gas Nozzle, con. ¹ NW16 L=84mm (PU =10)			
6	2360803	Gas Nozzle, tapered. NW12 L=84mm (PU =10)			
7	2360805	Spot Welding Gas Nozzle NW17 L=84mm (PU=10)			
8	2360113	Swan Neck SB360G AUT – 45°			
9	2360103	Swan Neck SB360G AUT – 180°			
20	2411009S	Handle Tube AUT			
21	2411622	Cable Support Spring fitting Handle Tube			
22	0233747	Flat Head Machine Screw M4x6			



Pos.	Part No.	Description	Pos.	Part No.	Description
100	34120X0	PTFE- Liner 2,0x4,0mm / Xm red	103	2155740	Collet for PTFE Liner Ø4,0mm (PU =10)
	34727X0	PTFE- Liner 2,7x4,7mm / Xm yellow		2415748	Collet for PTFE Liner Ø4,7mm (PU =10)
	35120X0	Carbon-PTFE- Liner 2,0x4,0mm / Xm	103.1	0031500	O-Ring (PU =10)
	35127X0	Carbon -PTFE- Liner 2,7x4,7mm / Xm	104	2415640	Collet for Steel Liner Ø4,0mm (PU=10)
	35220X0	PA- Liner 2,0x4,0mm / Xm		24155645	Collet for Steel Liner Ø4,5mm (PU=10)
	35323X0	PA- Liner 2,3x4,7mm / Xm			
	35327X0	PA- Liner 2,7x4,7mm / Xm			
101	34120X0K	PTFE- Liner 2,0x4,0mm / Xm red			
	34727X0K	PTFE- Liner 2,7x4,7mm / Xm gelb			
	35120X0K	Carbon -PTFE- Liner 2,0x4,0mm / Xm			
	35127X0K	Carbon -PTFE- Liner 2,7x4,7mm / Xm			
	35320X0K	PA- Liner 2,0x4,0mm / Xm			
	35323X0K	PA- Liner 2,3x4,7mm / Xm			
	35327X0K	PA- Liner 2,7x4,7mm / Xm			
102	34420X0	Steel liner 2,0x4,0mm / Xm ¹ coated red			
	34425X0	Steel liner 2,5x4,0mm / Xm coated yellow			

Liner in standard length 3m/4m/5m. Please insert the length at X.
Example: Steel Liner 4m = 3442040

¹ Included in standard equipment welding torch cpl.