

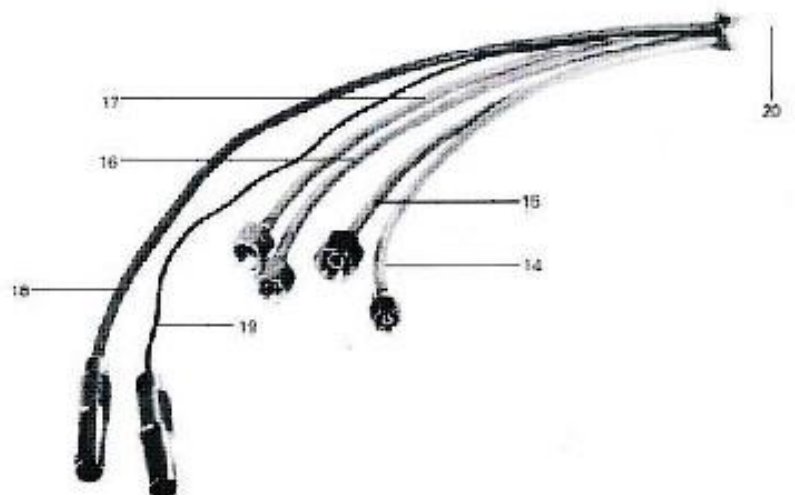

Manual Welding Torch PHW 50, water cooled

Technical data according to EN 60 974-7

Rating:	50A DC
	30A AC
Duty cycle:	@100%
Plasma gas:	Argon
Shielding gas:	Argon/Hydrogen

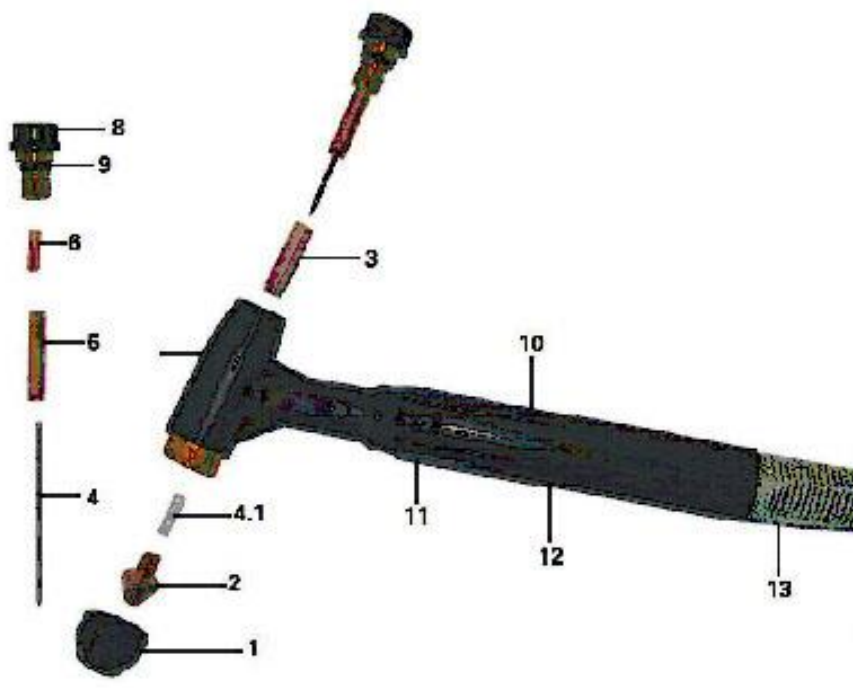



Part Number for complete Welding Torch

Part No.	3m
PHW 50	75303136
PHW 51	75303651

Spare Part List

Pos.	Part No.	Description	Pos.	Part No.	Description
1	75303161	Gas Nozzle	13	75303165	Cable Assembly PHW 50 kpl. 3 m
2	75303840	Orifice Insert, Negative Pole 12 A - 0,8 mm		75303166	Water Hose M12 x 1
	75303841	Orifice Insert, Negative Pole 30 A - 1,0 mm		75303170	Water Hose G 3/8
	75303842	Orifice Insert, Negative Pole 40 A - 1,2 mm		75303167	Plasma Gas Hose G 1/4
	75303843	Orifice Insert, Negative Pole 50 A - 1,4 mm		75303168	Schielding Gas Hose G 1/4 LH
	75303328	Orifice Insert, Positive Pole 20 A - 1,2 mm		75303169	Cable, Main Arc
	75303329	Orifice Insert, Positive Pole 25 A - 1,6 mm		75300895	Cable, Auxiliary Arc
	75303331	Orifice Insert, Positive Pole 30 A - 2,0 mm		445326	Cover Hose (per m)
3	75303315	Insulating Sleeve		75303648	Cable Assembly PHW 51 kpl. 3m
4	75303845	Electrode Negative Pole - 1,0 x 65 mm - WL 10		75303166	Water Hose M12 x 1
	75303246	Guide for Electrode - WL1,0		75303170	Water Hose G 3/8
	75303156	Electrode Negative Pole - 1,6 x 65 mm - WL 10		75303167	Plasma Gas Hose G 1/4
	75303157	Electrode Positive Pole - 2,4 x 65 mm - WL 10		75303168	Schielding Gas Hose G 1/4 LH
4.1	75303366	Center Piece 1,6 mm		75303649	Cable, Main Arc
5	75303316	Nut 1,6 mm		75303646	Cable, Auxiliary Arc
	75303317	Nut 2,4 mm			
6	75303844	Collet 1,0 mm	20	75303846	Electrode Adjustment Tool 1,6 mm
	75303318	Collet 1,6 mm		75303323	Electrode Adjustment Tool 2,4 mm
	75303210	Collet 2,4 mm		75200558	Connection G 1/8 x G 3/8, Uniwig G200P
7	75303137	Torch Body		75200487	Connection G 1/8 x M12 x 1, Uniwig G200P
8	75303149	Clamping Screw		75300418	Connection G 1/8 x G 1/4, Uniwig G200P
9	75303149	O-Ring 7,65 x 1,78			
10	75303650	Handle			
11	18701550	Flat Head Maschine Screw M5 x 7			
12	41232110	Threaded Ring M3 x 4 (2 Stck)			