



## Machine-and Manual-Welding Torch PHB/PMB 50, water cooled

### Technical data according to EN 60 974-7

Rating	50A DC
Gas Supply:	Plasma gas / shielding gas
Duty Cycle:	@60%
Plasma gas:	G1/4"
Shielding gas:	G1/4", left



Optional with handle  
incl. double switch

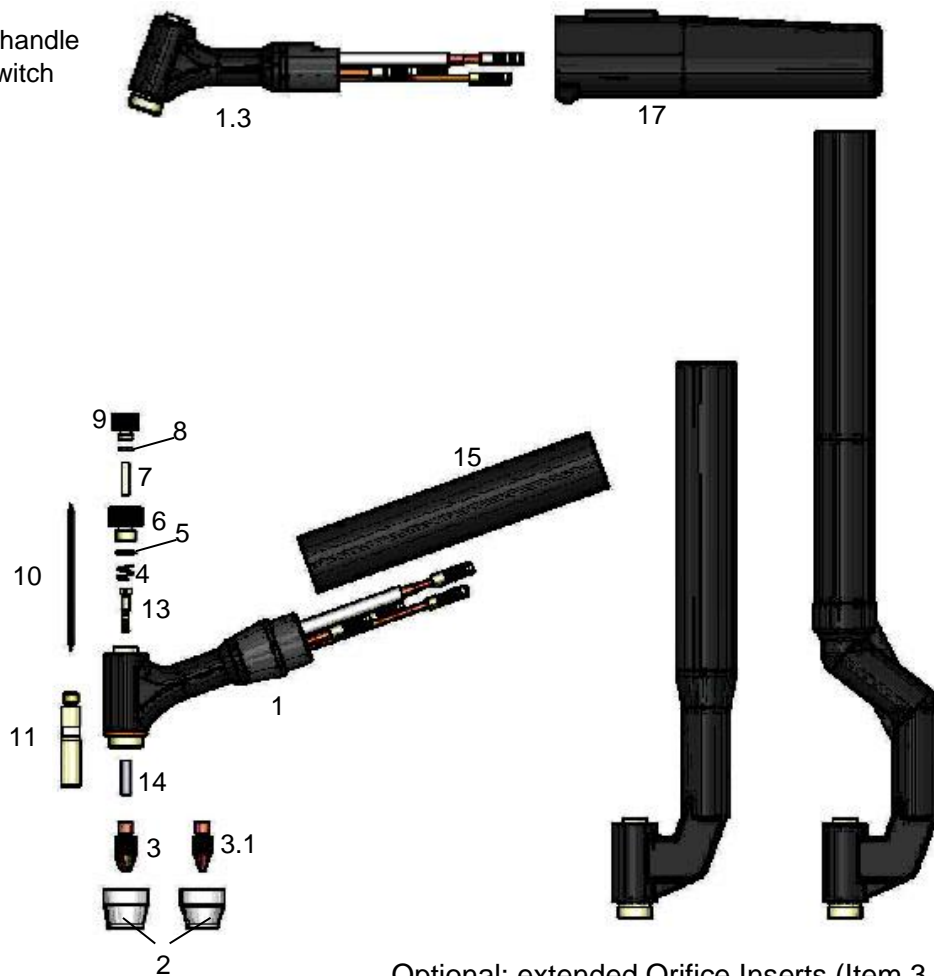

Optional: extended Orifice Inserts (Item 3.2 and 3.3)

Standard:



2mm extended:



5mm extended:





### Part Number for complete Welding Torch

Part No	3m
Welding Torch cpl.	50010000
Machine Torch cpl.	50020000
Machine Torch angular, cpl.	50030000

### Spare Part List

Pos.	Part No.	Description	Pos.	Part No.	Description
1	50010001	Torch Body Manual Torch PHB 50	3.3	500100111	Orifice Insert 1,0 mm, 5mm extended
1.1	50020001	Torch Body Machine Torch PMB 50		500100112	Orifice Insert 1,2 mm, 5mm extended
1.2	50030001	Torch Body Machine Torch PMB 50 angular		500100114	Orifice Insert 1,4 mm, 5mm extended
1.3	50030001	Torch Body PHB 50 to fot into trigger-handle		500100116	Orifice Insert 1,6 mm, 5mm extended
				500100118	Orifice Insert 1,8 mm, 5mm extended
2	50010019	Ceramic Gas Nozzle LW = 11 mm	4	50010006	Spring
	50010026	Ceramic Gas Nozzle LW = 9,5 mm	5	50010020	O - Ring
3	50010009	Orifice Insert 0,6 mm	6	50010004	Collet Body Assembling (c/w O - Ring)
	50010010	Orifice Insert 0,8 mm	7	50010007	Collet 1,0 mm
	50010011	Orifice Insert 1,0 mm		50010008	Collet 1,5 mm
	50010012	Orifice Insert 1,2 mm	8	50010021	O - Ring
	50010013	Orifice Insert 1,4 mm	9	50010005	Back Cap with O-Ring
	50010014	Orifice Insert 1,6 mm	10	50010017	Tungsten Electrode 1,0 mm, 62 mm long
	50010015	Orifice Insert 1,8 mm		50010018	Tungsten Electrode 1,5 mm, 62 mm long
3.1	50010027	Orifice Insert 0,6 mm	13	50010022	Electrode Guiding Piece 1,0 mm
	50010028	Orifice Insert 0,8 mm		50010024	Electrode Guiding Piece 1,5 mm
	50010029	Orifice Insert 1,0 mm	14	50010016	Centering Bushing Ceramic 1,0 mm
	50010030	Orifice Insert 1,2 mm		50010023	Centering Bushing Ceramic 1,5 mm
3.2	50011010	Orifice Insert 0,8 mm, 2mm extended	15	50010002	Handle Tube Machine Torch / Manual Torch
	50011011	Orifice Insert 1,0 mm, 2mm extended	16	50050001	Electrode Adjustment Tool
	50011012	Orifice Insert 1,2 mm, 2mm extended	17	75200779S1	Handle cpl. incl. micro-switch
	50011013	Orifice Insert 1,4 mm, 2mm extended		50040000x	Cable Assembly cpl. 3m
	50011014	Orifice Insert 1,6 mm, 2mm extended			Please state the machine side connections
	50011015	Orifice Insert 1,8 mm, 2mm extended	Without picture	50010025	Spare Part Box, without spares