



Manual Welding Torch M 600 W, water cooled



Technical data according to EN 60 974-7

Rating:

CO ₂ :	600A
Mixed gas M21:	500A
Duty cycle:	@100%
Wire-Ø:	0,8 – 1,6mm

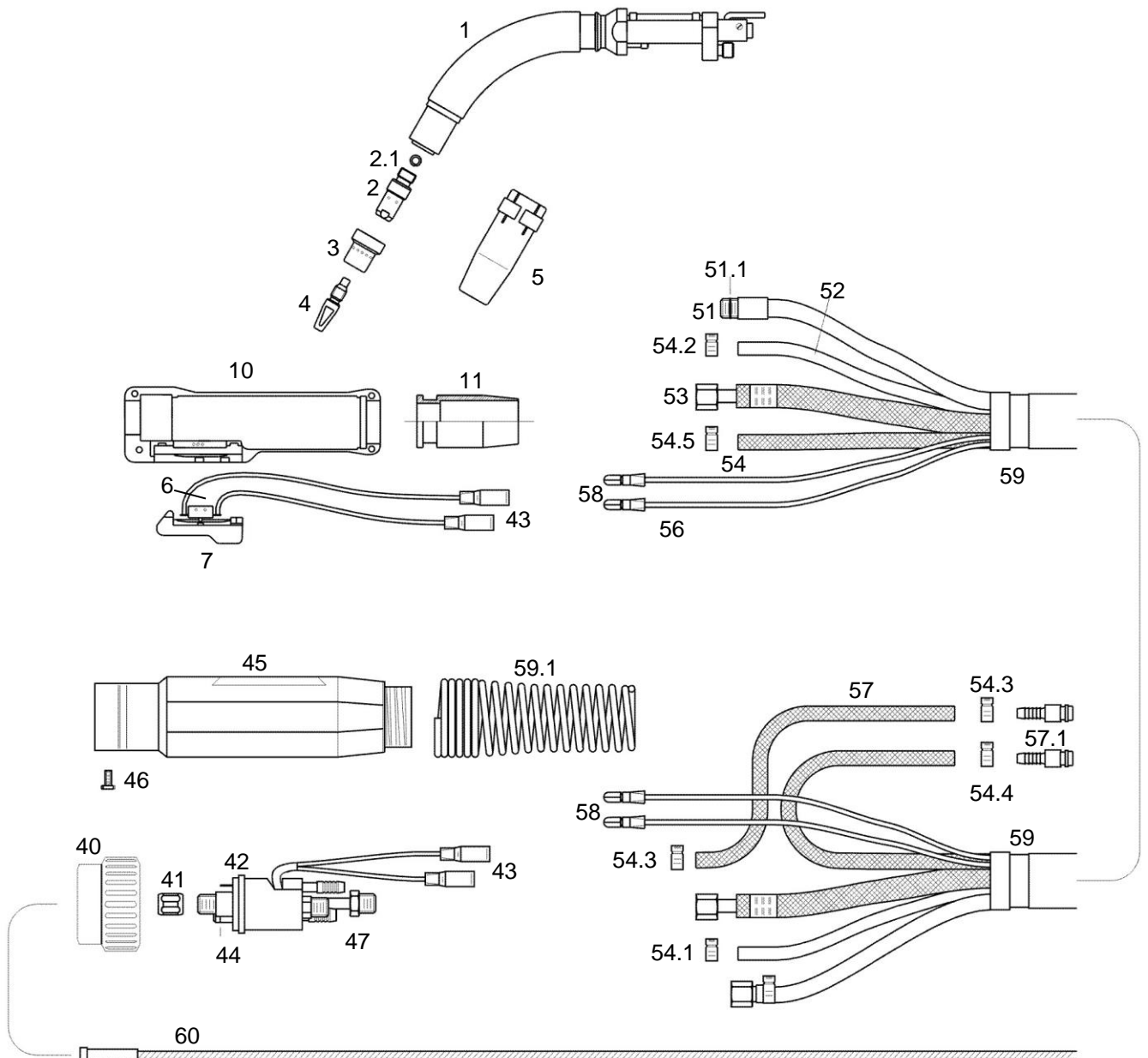



Part Number for complete Welding Torch

Part No.	3m	4m
Torch neck 45° Euro-Connector	75106731	75106734
Torch neck, short 45° Euro-Connector	75106733	75106736
Torch neck 60° Euro-Connector	75106732	75106735

Spare Part List

Pos.	Part No.	Description	Pos.	Part No.	Description
1	75106716	Torch neck 45 °	43	2155100	Female Electrical Connector
	75106718	Torch neck 45° short	44	0041000	O - Ring
	75106717	Torch neck 60°	45	2411600S1	Gun Plug Housing 3 pieces
2	75106520	Tip Adapter	46	0040601	Screw
2.1	41209055	Spring Ring	47	76585005	Liner Conduit Fitting WZ/ML
3	75106596	Gas Diffusor	51	75120277	Liner Conduit ZA-E
4	41150310	Contact Tip ø 0,8 mm		75120280	Liner Conduit ZA-E
	41150320	Contact Tip ø 1,0 mm	51.1	46209020	O - Ring
	41150180	Contact Tip ø 1,2 mm	52	0550111	Gas Hose (per m)
	41150450	Contact Tip ø 1,6 mm	53	75105358	Power Cable cpl. 3m
5	75106484	Gas Nozzle, conical, ø 13 mm		75105359	Power Cable cpl. 4m
	75106483	Gas Nozzle, conical, ø 17 mm	54	75106192	Water Inlet Hose cpl. 3m
	75106483B	Gas Nozzle, conical with gliss coat coating		75106193	Water Inlet Hose cpl. 4m
6	75102359	Micro Switch	54.1	03210951	Single Ear Clamp, 9,5
7	75105190	Trigger	54.2	03210801	Single Ear Clamp, 8,5
10	75103169	Handle cpl.	54.3	03210051	Single Ear Clamp, 10,5
11	75102356	Gun Plug Housing	54.4	03211001	Single Ear Clamp, 10,0
40	2151700	Plug Nut	54.5	03210901	Single Ear Clamp, 9,0
41	2151501	Liner Positioner Nut	56	0500201	Control Cable (per m)
42	75199012	Gun Plug Body ML water cooled	57	2414705	Water Outlet Hose cpl. 0,55m
	2411505	Gun Plug Body with Spring loaded Pins	57.1	2990800	Water Nipple



Pos.	Part No.	Description	Pos.	Part No.	Description
60	2415640	Collet for Steel Liner 4,0mm			
	2415645	Collet for Steel Liner 4,5mm			
	2155740	Collet for PTFE-Liner 4,0mm			
	2415747	Collet for PTFE-Liner 4,7mm			
	3401531	Steel Liner 1,5 x 4,0 mm / 3 m			
	3401541	Steel Liner 1,5 x 4,0 mm / 4 m			
	3401551	Steel Liner 1,5 x 4,0 mm / 5 m			
	3412030	PTFE-Liner 2,0 x 4,0 mm / 3 m			
	3412040	PTFE-Liner 2,0 x 4,0 mm / 4 m			
	3412050	PTFE-Liner 2,0 x 4,0 mm / 5 m			
	3452031	Steel Liner 2,0 x 4,5 mm / 3 m			
	3452041	Steel Liner 2,0 x 4,5 mm / 4 m			
	3452051	Steel Liner 2,0 x 4,5 mm / 5 m			
	3452531	Steel Liner 2,5 x 4,5 mm / 3 m			
	3452541	Steel Liner 2,5 x 4,5 mm / 4 m			
	3452551	Steel Liner 2,5 x 4,5 mm / 5 m			
	3472730	PTFE-Liner 2,7 x 4,7 mm / 3 m			
	3472740	PTFE-Liner 2,7 x 4,7 mm / 4 m			
	3472750	PTFE-Liner 2,7 x 4,7 mm / 5 m			
	3512030	Carbon-PTFE-Liner 2,0 x 4,0 mm / 3 m			
	3512040	Carbon-PTFE-Liner 2,0 x 4,0 mm / 4 m			
	3512050	Carbon-PTFE-Liner 2,0 x 4,0 mm / 5 m			
	3572730	Carbon-PTFE-Liner 2,7 x 4,7 mm / 3 m			
	3572740	Carbon-PTFE-Liner 2,7 x 4,7 mm / 4 m			
	3572750	Carbon-PTFE-Liner 2,7 x 4,7 mm / 5 m			
	0031500	O - Ring			