

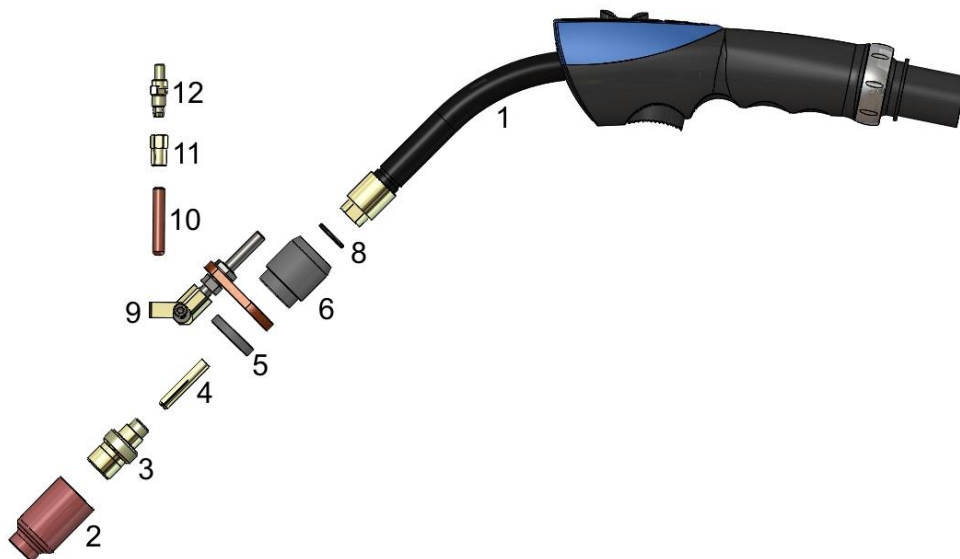

## Hot/Cold Wire TIG Welding Torch M-TIG400W, water cooled

Technical data according to EN 60 974-7

Rating:	350 A DC
	300 A AC
Duty cycle	@100%
Tungsten electrodes:	Ø1,6 – 3,2mm





### Spare Parts List

Pos.	Part.No.	Description	Pos.	Part.No.	Description
1	105032000	Torch Body M-TIG350W	6	105032005	Insulator M-TIG
2	1210704	Ceramic nozzle # 4 (54N18)	8	0132000	O-Ring
	1210705	Ceramic nozzle # 5 (54N17)	9	105031120	Hot Wire Mounting, cpl.
	1210706	Ceramic nozzle # 6 (54N16)	10	105031047	Hot Wire Tip 0,8
	1210707	Ceramic nozzle # 7 (54N15)		105031048	Hot Wire Tip 1,0
	1210708	Ceramic nozzle # 8 (54N14)		105031049	Hot Wire Tip 1,2
	1210712	Ceramic nozzle # 12 (54N19)		105031050	Hot Wire Tip 1,4
3	200031222	Gas Lens 1,6	11	105031102	Clamping Element
	200031223	Gas Lens 2,4	12	105031104	Clemping Screw
	200031224	Gas Lens 3,2			
4	200031212	Collet 1,6			
	200031213	Collet 2,4			
	200031214	Collet 3,2			
5	1050323	Insulator front			