



## Manual Welding Torch M-AR 240W CR, water cooled

Technical Data according to EN 60 974-7

Rating:

CO <sub>2</sub> :	325A
Mixed gas M21:	300A
Duty cycle:	@100%
Wire-Ø:	0,8 – 1,2mm

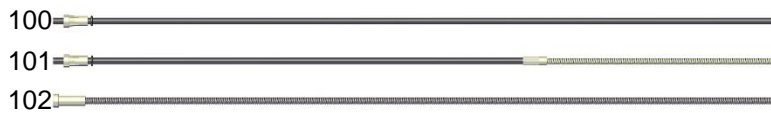
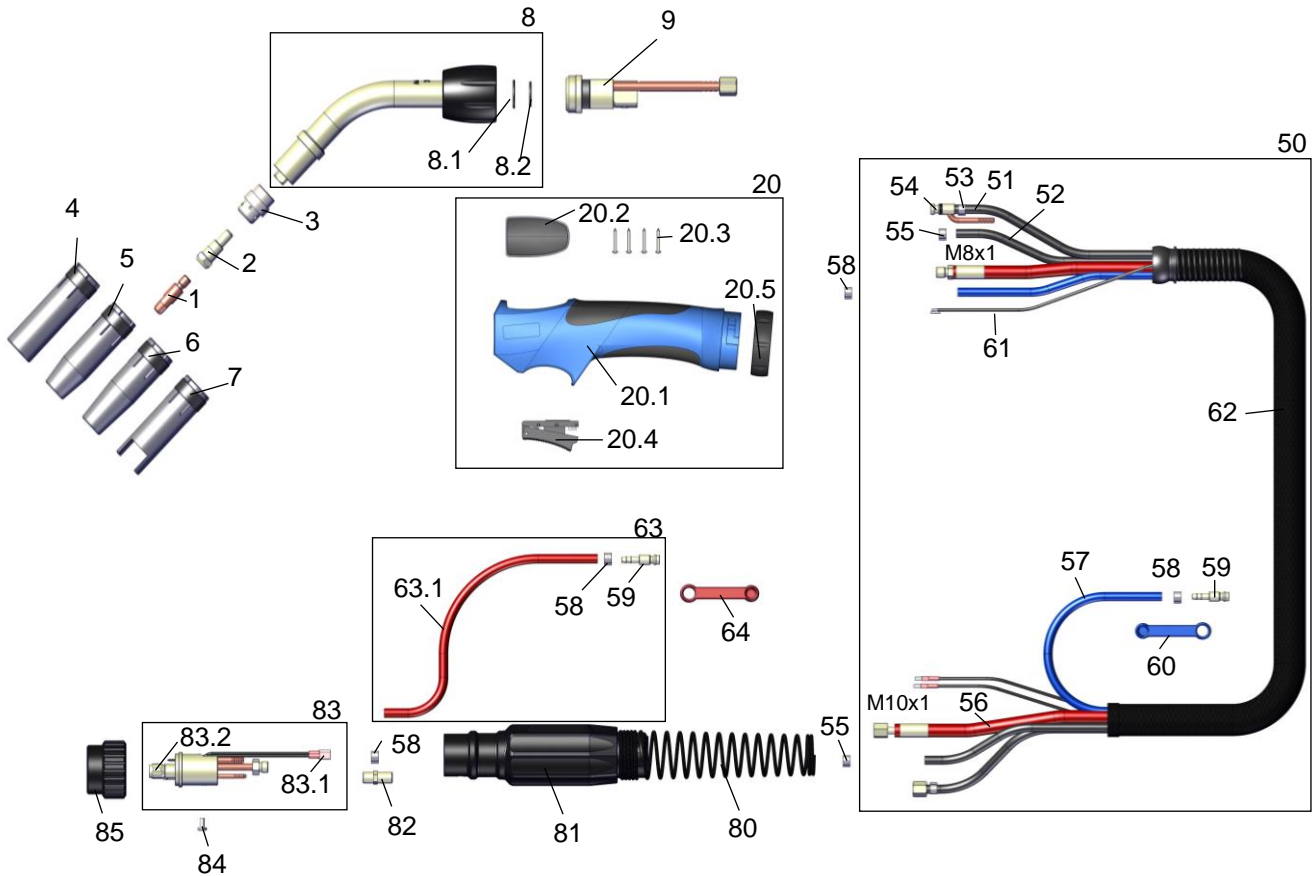

### Part Number for complete Welding Torch

Standard equipment for Ø 1,0mm

	3m	4m	5m
M-AR 240W CR cpl. with blue handle, Euro-connection (Steel Liner 2,0x4,5mm)	2219M30200	2219M40200	2219M50200
M-AR 240W CR cpl. with grey handle, Euro-connection (Steel Liner 2,0x4,5mm)	2219M30100	2219M40100	2219M50100



## Spare Part List

Pos.	Part No.	Description	Pos.	Part No.	Description
1	22506xx	Contact Tip M6x28, $\varnothing$ in mm / ECu <sup>1</sup> (PU=10)	50	24139M30	Cable Assembly M-AR cpl. 3m
	22576xx	Contact Tip M6x28, $\varnothing$ in mm / CuCrZr (PU=10)		24139M40	Cable Assembly M-AR cpl. 4m
	22566xx	Contact Tip M6x28, $\varnothing$ in mm / for Alu (PU=10)		24139M50	Cable Assembly M-AR cpl. 5m
	<i>Contact Tips available in <math>\varnothing</math> 0.8/0.9/1.0/1.2mm</i>		51	25146M30	Outer Liner M-AR cpl. 3m
	<i>Please insert wire diameter at <b>xx</b>.</i>			25146M40	Outer Liner M-AR cpl. 4m
	<i>Example: <math>\varnothing</math> 1,2 mm is: 12; Part No.: = 2250612</i>			25146M50	Outer Liner M-AR cpl. 5m
2	2240406	Tip Adapter M6 short <sup>1</sup> (PU=5)	52	0550111	Gas Hose $\varnothing$ 5,0x1,5 (PU=100m)
3	2240702	Gas Diffuser, white <sup>1</sup> (PU=5)	53	03211181	Single Ear Clamp D=11,8 (PU=100)
	2240700	Gas Diffuser, black (PU=5)	54	21201027	Wire-Gas-Connector
	2240701	Gas Diffuser, silicon red (PU=5)	55	03210871	Single Ear Clamp D=8,7 (PU=100)
4	2240801	Gas Nozzle, cylin. NW17 L=63,5mm (PU=5)	56	2414130	Power Cable cpl. 3m
5	2240802	Gas Nozzle, con. NW12,5 L=63,5mm <sup>1</sup> (PU=5)		2414140	Power Cable cpl. 4m
6	2240803	Gas Nozzle, tapered NW10 L=63,5mm (PU=5)		2414150	Power Cable cpl. 5m
7	2240805	Spot Welding Gas Nozzle NW17 L=63,5mm (PU=5)	57	0550105	Water Hose blue $\varnothing$ 5,0x1,5, (PU=100m)
8	2219M100	Swan Neck M-AR 240W CR	58	03211001	Single Ear Clamp D=10,0 (PU=100)
8.1	0131501	O-Ring 13,0x1,5mm (PU=20)	59	2990800	Water Hose Nipple (PU=10)
8.2	67329001	O-Ring 10,0x1,5mm (PU=20)	60	45050339	Water Stop blue (PU=10)
9	2990M900	Inner body watercooled for M-AR	61	24144M30	Control Cable M-AR cpl. 3m
20	2114001K	MIG-Handle AR-K2, blue cpl. neutral top		24144M40	Control Cable M-AR cpl. 4m
	2114001K1	MIG-Handle AR-K2, grey cpl. neutral top		24144M50	Control Cable M-AR cpl. 5m
20.1	2114001	MIG-Handle AR-K2, blue, left + right half	62	24145M30	Cover Hose M-AR cpl. 3m
	21140012	MIG-Handle AR-K2, grey, left + right half		24145M40	Cover Hose M-AR cpl. 4m
20.2	2114007	Neutral top, AR-K2		24145M50	Cover Hose M-AR cpl. 5m
20.3	2114012	Screw for Handle(4) (PU=20)	63	2414705	Water Outlet Hose cpl. 0,55m
20.4	2114006	Trigger cpl. AR-K2	63.1	0550108	Water Hose red $\varnothing$ 5,0x1,5 (PU=100m)
20.5	2114002	Nut for Handle AR-K2	64	45050340	Water Stop red (PU=10)

<sup>1</sup> Included in standard configuration



Pos.	Part No.	Description	Pos.	Part No.	Description
80	2411611	Cable Support Spring	100	34115X0	PTFE-Liner 1,5x4,0mm / Xm blue
81	2411600S1	Plug Housing, without nut		34120X0	PTFE-Liner 2,0x4,0mm / Xm red
82	2411501	Threaded Nipple		34727X0	PTFE-Liner 2,7x4,7mm / Xm yellow
83	2411505	Gun Plug Body with Spring Loaded Pins		35120X0	Carbon-PTFE-Liner 2,0x4,0mm / Xm black
83.1	2155100	Female Electrical Connector, insulated (PU=20)		35127X0	Carbon-PTFE-Liner 2,7x4,7mm / Xm black
83.2	2151501	Liner Positioner Nut		35220X0	PA-Liner 2,0x4,0mm / Xm anthracite
84	0040601	Screw M4x6 (1) (PU=20)		35323X0	PA-Liner 2,3x4,7mm / Xm anthracite
85	2151700	Plug Nut		35327X0	PA-Liner 2,7x4,7mm / Xm anthracite
			101	34115X0K	Combi-PTFE-Liner 1,5x4,0mm / Xm blue
				34120X0K	Combi-PTFE-Liner 2,0x4,0mm / Xm red
				34727X0K	Combi-PTFE-Liner 2,7x4,7mm / Xm yellow
				35120X0K	Combi-Carbon-PTFE-Liner 2,0x4,0mm / Xm black
				35127X0K	Combi-Carbon-PTFE-Liner 2,7x4,7mm / Xm black
				35320X0K	Combi-PA-Liner 2,0x4,0mm / Xm anthracite
				35323X0K	Combi-PA-Liner 2,3x4,7mm / Xm anthracite
				35327X0K	Combi-PA-Liner 2,7x4,7mm / Xm anthracite
			102	34015X1	Steel Liner 1,5x4,0mm / Xm blank
				34520X1	Steel Liner 2,0x4,5mm / Xm <sup>1</sup> blank
				34525X1	Steel Liner 2,5x4,5mm / Xm blank

*Liners available in 3m/4m/5m length. Please insert length at X.  
Example: Steel-Liner 4m = 3402041*

<sup>1</sup> Included in standard configuration