



Manual Welding Torch FKS 500W, water cooled

Technical data according to EN 60 974-7

Rating:

CO ₂ :	560A
Mixed gas M21:	520A
Duty cycle:	@100%
Wire-Ø:	0,8 – 1,6mm

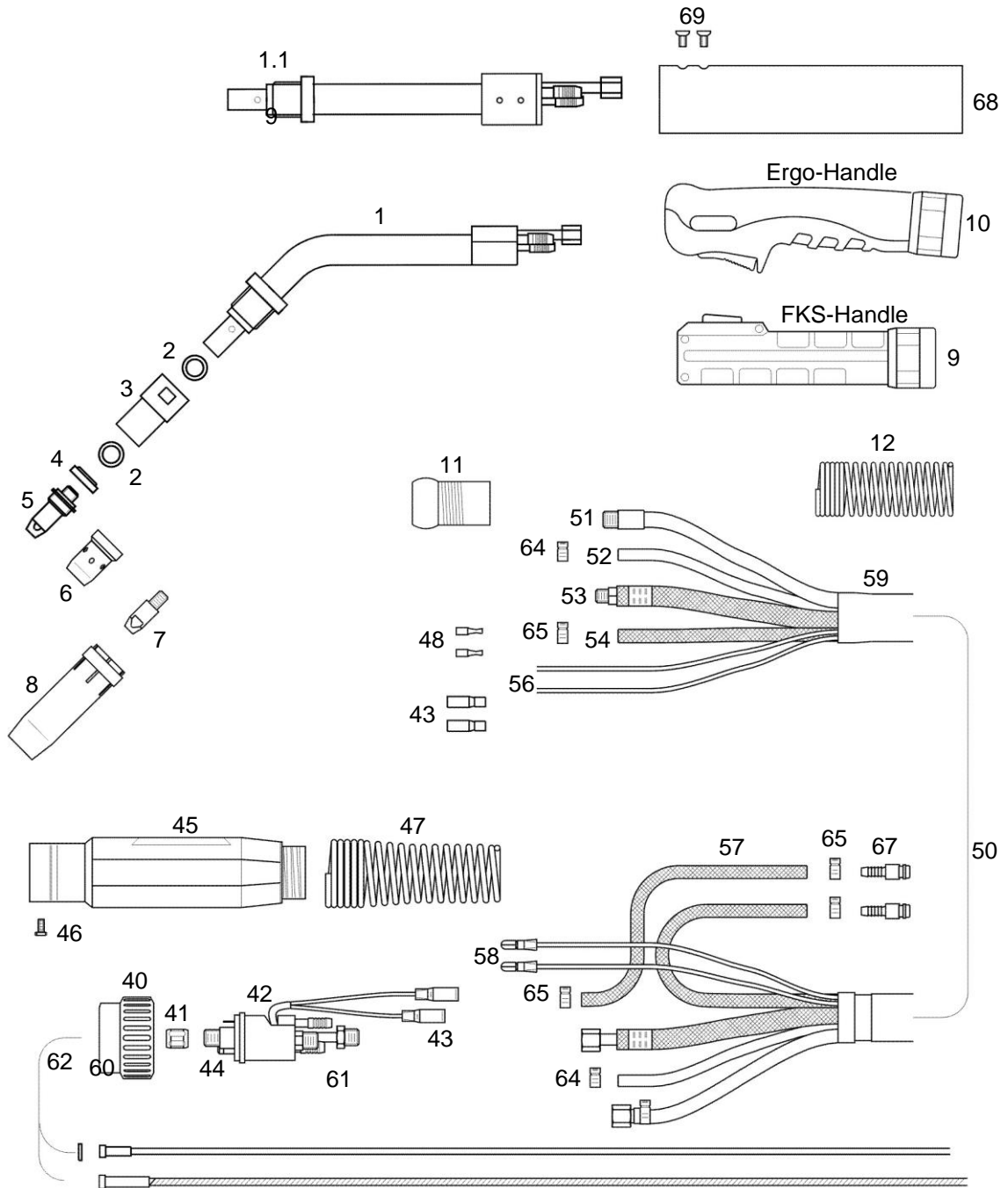



Part number for complete Welding Torch

Part. No.	3m	4m	5m
Ergo-Handle, Micro Blade	2543030	2544030	2545030
Ergo- Handle, Blade Switch	2543050	2544050	2545050
FKS- Handle Trigger on Top	2543002	2544002	2545002
FKS- Handle Bottom Trigger	2543001	2544001	2545001

Spart Part List

Pos.	Part. No.	Description	Pos.	Part. No.	Description
1	2534102	Torch neck FKS 500, Bottom Trigger	40	2151700	Nut
	2540101	Torch neck FKS 500, Trigger on top	41	2151501	Liner Positioner Nut
2	0122500	O - Ring	42	2411500	Gun Plug Body, water cooled
3	2540500	Water Cooling Unit for Gas Nozzle		2411505	Gun Plug Body with Spring Loaded Pins
4	2540201	Insulating Ring	43	2155100	Male Electrical Connector, insulated (Handle Pos.9)
5	2540408	Tip Adapter	44	0041000	O-Ring
6	2410705	Gas Diffusor Standard FKS 500	45	2411600S1	Gun Plug Housing
6	2410705K	Gas Diffusor Keramik FKS 500	46	0040601	Screw
7	24106xx	Contact Tip M 8 x 30, ø in mm ECU	47	2411611	Cable Support Spring
	24176xx	Contact Tip M 8 x 30, ø in mm CuCrZr	48	2415304	Female Electrical Connector (Handle Pos.10)
	<i>Tips available in ø 0.8/0.9/1.0/1.2/1.4/1.6 mm</i>				
	<i>Please insert wire diameter at xx. Example:</i>				
	<i>ø 0,8 mm is: 08; Part.-No.: = 2410608</i>				
8	2410801	Gas Nozzle, conical	50	2413930	Cable Assembly cpl. 3 m
	2410802	Gas Nozzle, tapered		2413940	Cable Assembly cpl. 4 m
	2410803	Gas Nozzle pointed		2413950	Cable Assembly cpl. 5 m
9	2531088	Handle FKS, complete	51	2514630	Liner Conduit 3 m
10	2111188	Ergo-Handle cpl.		2514640	Liner Conduit 4 m
11	2111175	Swivel		2514650	Liner Conduit 5 m
12	2111195	Cable Support Spring	52	2414330	Gas Hose 3 m
				2414340	Gas Hose 4 m
				2414350	Gas Hose 5 m



Pos.	Part No.	Description	Pos.	Part No.	Description
53	2414130	Power Cable cpl. 3 m	64	0321087	Single Ear Clamp 8,7
	2414140	Power Cable cpl. 4 m	65	0321095	Single Ear Clamp 9,5
	2414150	Power Cable cpl.. 5 m	67	2990800	Water Hose Nipple
54	2414230	Water Inlet House cpl. 3 m	68	2531009	Handle Tube AUT
	2414240	Water Inlet House cpl. 4 m	69	2531010	Screw
	2414250	Water Inlet House cpl. 5 m			
56	2414430	Control Cable 3 m			
	2414440	Control Cable 4 m			
	2414450	Control Cable 5 m			
57	2414705	Water Outlet Hose 0,55 m			
58	2155200	Male Electrical Connector, insulated			
59	2534530	Cover Hose cpl. 3 m			
	2534540	Cover Hose cpl. 4 m			
	2534550	Cover Hose cpl. 5 m			
60	2155640	Collet for Steel Liner 4,0 mm			
	2415745	Collet for Steel Liner 4,5 mm			
	2155740	Collet for PTFE Liner 4,0 mm			
	2415747	Collet for PTFE Liner 4,7 mm			
61	3452031	Steel Liner 2,0 x 4,5 mm / 3 m			
	3452041	Steel Liner 2,0 x 4,5 mm / 4 m			
	3452051	Steel Liner 2,0 x 4,5 mm / 5 m			
	3412030	PTFE- Liner 2,0 x 4,0 mm / 3 m			
	3412040	PTFE- Liner 2,0 x 4,0 mm / 4 m			
	3412050	PTFE- Liner 2,0 x 4,0 mm / 5 m			