



## Manual Welding Torch FKS 400WD, water cooled

### Technical Data according to EN 60 974-7

Rating:

CO <sub>2</sub> :	400A
Mischgas M21:	350A
Duty cycle:	@100%
Wire -Ø:	0,8 – 1,2mm

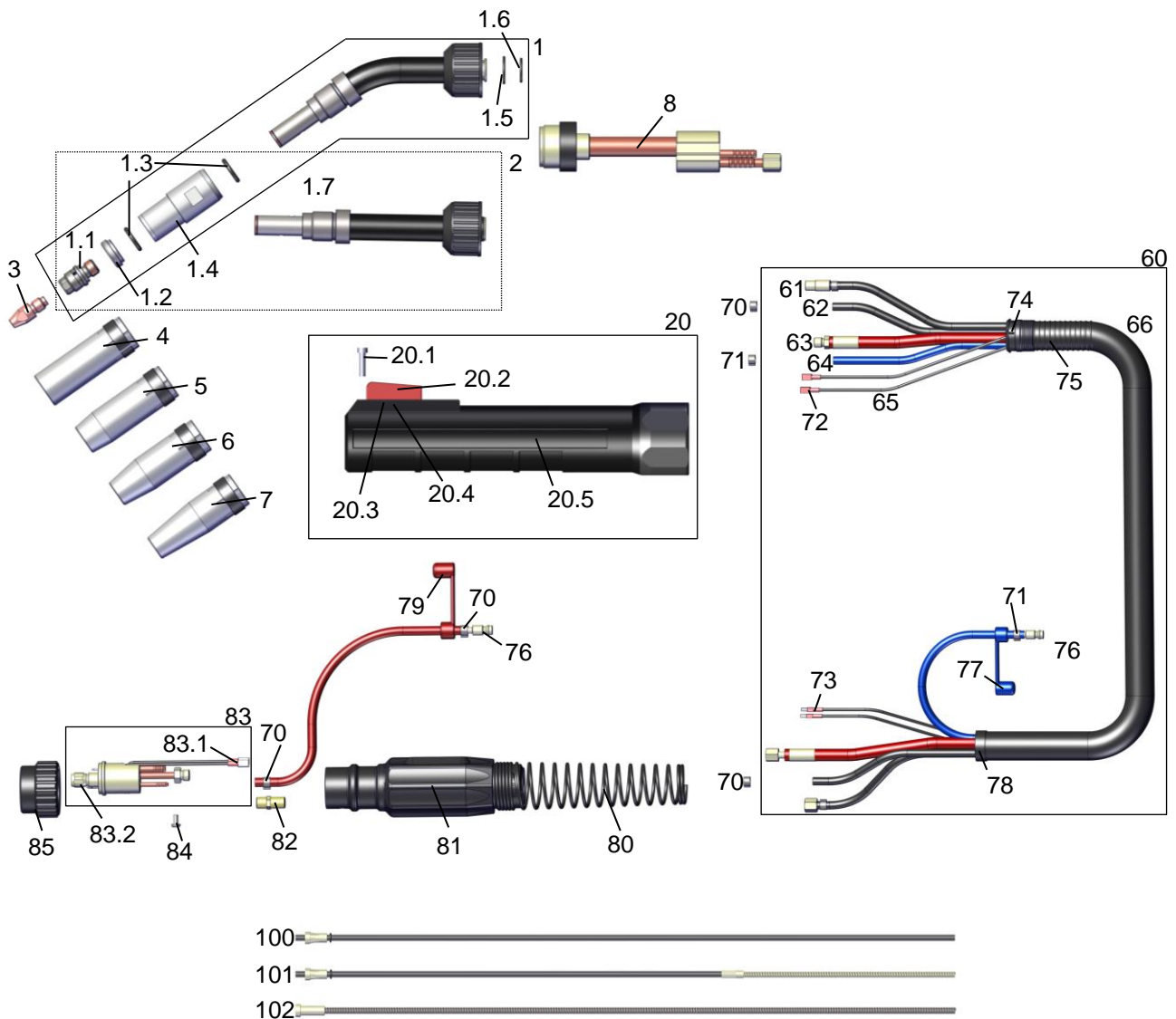

### Part Number for complete Welding Torch

	3m	4m	5m
FKS 400W cpl. with turnable torch neck, Euro-connection (Steel liner 2,5x4,5mm)	2533006	2534006	2525006



## Spare Part List

Pos.	Part No	Description	Pos.	Part No	Description
1	2530105	Torch neck FKS400W, 45°-change- able		2514650	Outer Liner 5m cpl.
1.1	2530408S2	Tip Adapter M8	62	0550111	Gas hose Ø 4,0x1,5 (PU=100m)
	2530406S2	Tip Adapter M6	63	2414130	Power Cable 3m cpl.
1.2	2530201	Insulating Ring		2414140	Power Cable 4m cpl.
1.3	0122500	O-Ring		2414150	Power Cable 5m cpl.
1.4	2530500	Water Cooling Unit for Gas Nozzle	64	0550105	Water Hose blue Ø 5,0x1,5, (PU=100m)
1.5	0131501	O-Ring 13x1,5	65	2414430	Control Cable 3m cpl.
1.6	0091500	O-Ring 9,5x1,5		2414440	Control Cable 4m cpl.
2	2530105S	Torch body FKS 400 changeable, straight		2414450	Control Cable 5m cpl.
3	24106xx	Contact Tip M8x30, ø in mm / ECu (PU=10)	66	2414530	Cover Hose cpl. 3m
	24176xx	Contact Tip M8x30, ø in mm / CuCrZr (PU=10)		2414540	Cover Hose cpl. 4m
	24166xx	Contact Tip M8x30, ø in mm / für Alu (PU=10)		2414550	Cover Hose cpl. 5m
	22506xx	Contact Tip M6x28, ø in mm / ECu (PU=10)	70	03210871	Single Ear ClampD=8,7 (PU=10)
	22576xx	Contact Tip M6x30, ø in mm / CuCrZr (PU=10)	71	03211001	Single Ear ClampD=10,0 (PU=10)
	22566xx	Contact Tip M6x30, ø in mm / für Alu (PU=10)	72	2415304	Female Electrical Connector (PU=20)
	Contact Tip available in ø 0.8/0.9/1.0/1.2/1.4/1.6 mm Please insert wire diameter at <b>xx</b> . example: ø 1,2 mm is: 12; part-no.: = 2410612		73	2155200	Male Electrical Connector, insulated (PU=20)
4	2530805	Gas nozzle, cylin. NW18 L=62mm (PU =10)	74	2111171	Cable Support gas for Ergo-Handle
	2530801	Gas nozzle, con. NW14,5 L=62mm <sup>1</sup> (PU=10)	75	2111195	Cable Support Spring Ergo-water
	2530802	Gas nozzle, tapered NW12 L=62mm (PU=10)	76	2990800	Water Hose Nipple (PU=10)
	2530803	Gas nozzle, pointed NW11,5 L=62mm (PU=10)	77	45050339	Waterstop blue (PU=10)
8	2410103	Connection body for turnable Neck	78	2411201	Cable Support
20	2531000	Handle FKS, cpl.	79	45050340	Waterstop red (PU=10)
	2531101	Screw (4) (PU=20)	80	2411611	Cable Support Spring
20.1	2531105	Trigger	81	2411600S1	Gun Plug Housing,without Nut
20.2	2531103	Micro switch cpl. with wire	82	2411501	Threaded Nipple
	2531104	Trigger spring	83	2411505	Central plug water-cooled, spring loaded pins
20.3	2531106	Handle FKS left & right half with nut	83.1	2155100	Female Electrical Connector, insulated (PU=20)
			83.2	2151501	Liner Positioner Nut
60	2413930	Cable assembly 3m cpl.	84	0040601	Screw (1) (PU=10)
	2413940	Cable assembly 4m cpl.	85	2151700	Plug Nut
	2413950	Cable assembly 5m cpl.			
61	2514630	Outer Liner 3m cpl.			
	2514640	Outer Liner 4m cpl.			



Pos.	Part No	Description	Pos.	Part No	Description
			100	34120X0	PTFE-Liner 2,0x4,0mm / X <sub>m</sub>
				34727X0	PTFE- Liner 2,7x4,7mm / X <sub>m</sub>
				35120X0	Carbon-Teflon Liner 2,0x4,0mm / X <sub>m</sub>
				35127X0	Carbon-Teflon Liner 2,7x4,7mm / X <sub>m</sub>
			101	34120X0K	PTFE-Brass Liner 2,0x4,0mm / X <sub>m</sub>
				34727X0K	PTFE- Brass Liner 2,7x4,7mm / X <sub>m</sub>
				35120X0K	Carbon-Teflon - Brass Liner 2,0x4,0mm / X <sub>m</sub>
				35127X0K	Carbon-Teflon - Brass Liner 2,7x4,7mm / X <sub>m</sub>
			102	34520X1	Steel Liner 2,0x4,5mm / X <sub>m</sub>
				34525X1	Steel Liner 2,5x4,5mm / X <sub>m</sub>

*Liners available in 3m/4m/5m length. Please insert length at X.  
Example: Steel-Liner 4m = 3452041*