



## Manual welding torch FKS 300WD, water cooled

Technical Data according to EN 60 974-7

Rating:

CO <sub>2</sub> :	380A
Mixed gas M21:	330A
Duty cycle:	@100%
Wire-Ø:	0,8 – 1,2mm

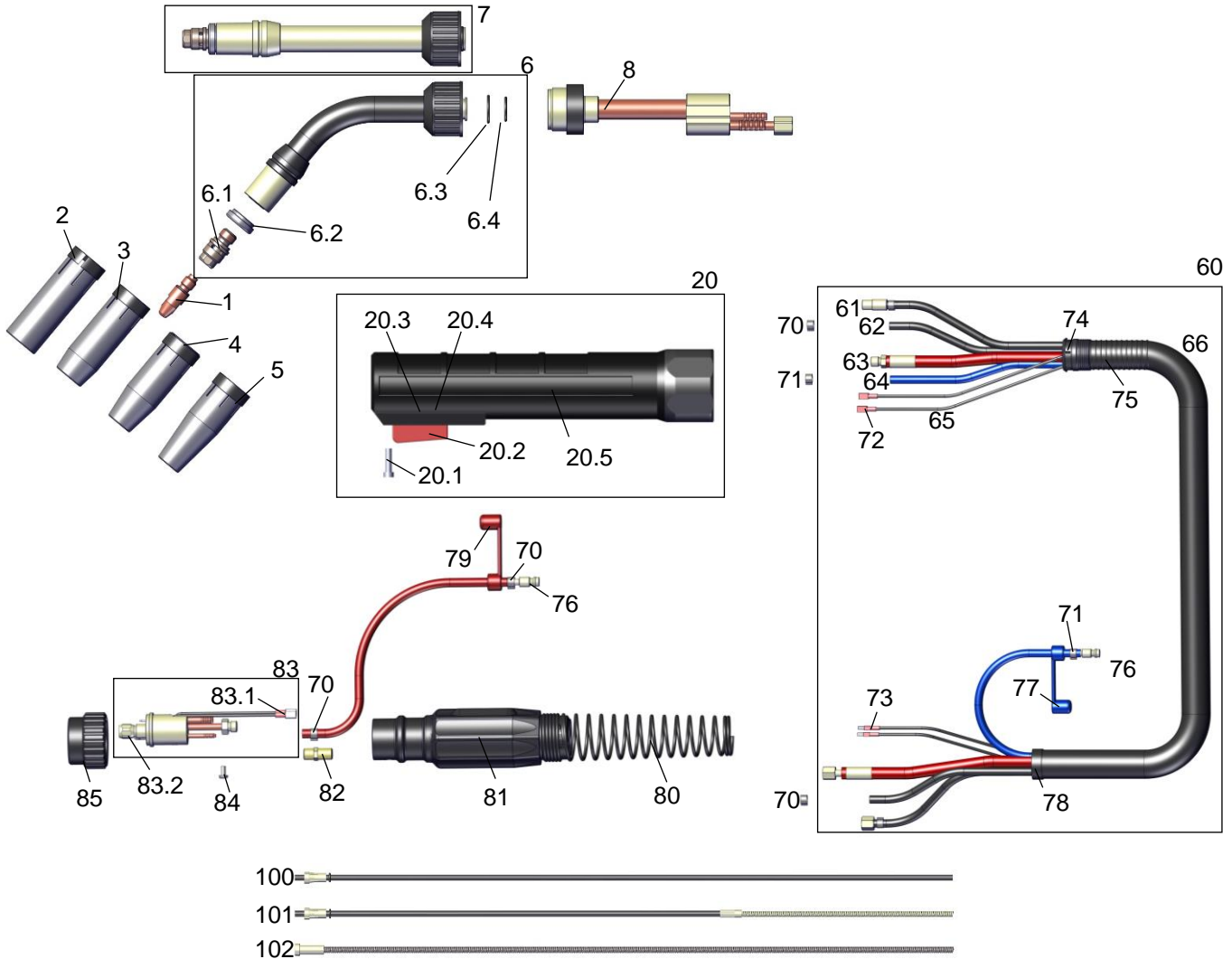

### Part Number for complete Welding Torch

Standard equipment for Ø 1,2mm

	3m	4m	5m
FKS 300W kpl. with 45° torch neck, Euro-connection (Steel Liner 2,5x4,5mm)	2523003	2524003	2525003



## Spare Part List

Pos.	Part No	Description	Pos.	Part No	Description
1	24106xx	Contact Tip M8x30, ø in mm / ECu <sup>1</sup> (PU=10)	60	2413930	Cable assembly 3m cpl.
	24176xx	Contact Tip M8x30, ø in mm / CuCrZr (PU=10)		2413940	Cable assembly 4m cpl.
	24166xx	Contact Tip M8x30, ø in mm / for Alu (PU=10)		2413950	Cable assembly 5m cpl.
	22506xx	Contact Tip M6x28, ø in mm / ECu (PU=10)	61	2514630	Liner Conduit 3m kpl.
	22576xx	Contact Tip M6x28, ø in mm / CuCrZr (PU=10)		2514640	Liner Conduit 4m kpl.
	22566xx	Contact Tip M6x28, ø in mm / for Alu (PU=10)		2514650	Liner Conduit 5m kpl.
	Contact Tips available in ø 0.8/0.9/1.0/1.2mm Please insert wire diameter at <b>xx</b> . Example: ø 1,2 mm is: 12; Part No= 2410612			0550111	Gas hose Ø 4,0x1,5 (PU=100m)
			63	2414130	Power cable 3m cpl.
2	2530805	Gas nozzle, cylin. NW18 L=62mm (PU=5)		2414140	Power cable 4m cpl.
3	2530801	Gas nozzle, con. <sup>1</sup> NW14,5 L=62mm (PU=5)		2414150	Power cable 5m cpl.
4	2530802	Gas nozzle, tapered NW12 L=62mm (PU=5)	64	0550105	Water hose blue Ø 5,0x1,5, (PU=100m)
5	2530803	Gas nozzle, pointed NW11,5 L=62mm (PU=5)	65	2414430	Control cable 3m kpl.
6	25201081	Torch neck 45° FKS 300WD		2414440	Control cable 4m kpl.
6.1	2530408S	Tip adapter M8 <sup>1</sup> (PU=5)		2414450	Control cable 5m kpl.
	2530406S2	Tip adapter M6 (PU=5)	66	2414530	Cover hose cpl. 3m
6.2	2530201	Insulating ring FKS		2414540	Cover hose cpl. 4m
6.3	0131501	O-Ring 13x1,5		2414550	Cover hose cpl. 5m
6.4	0091500	O-Ring 9,5x1,5	70	03210871	Single ear clamp D=8,7 (PU=100)
7	25201080	Torch neck FKS 300WD, straight	71	03211001	Single ear clamp D=10,0 (PU=100)
8	2410103	Inner body watercooled	72	2415304	Female Electrical Connector 2,8 x 0,8 (PU=20)
			73	2155200	Male Electrical Connector, insulated (PU=20)
20	2531000	Handle FKS, cpl.	74	2111171	Cable support f. Ergo-handle
20.1	2531101	Screw (4) (PU=20)	75	2111195	Cable support spring
20.2	2531105	Trigger	76	2990800	Water hose nipple (PU=10)
20.3	2531103	Micro switch cpl. with wire	77	45050339	Water Stop blue (PU=10)
20.4	2531104	Trigger spring	78	2411201	Gun plug housing
20.5	2531106	Handle FKS left & right half with nut	79	45050340	Water Stop red (PU=10))

<sup>1</sup> Included in standard configuration



Pos.	Part No	Description	Pos.	Part No	Description
80	2411611	Cable Support Spring	100	34120X0	PTFE-Liner 2,0x4,0mm / X <sub>m</sub> red
81	2411600S1	Plug Housing, without nut		34727X0	PTFE-Liner 2,7x4,7mm / X <sub>m</sub> yellow
82	2411501	Threaded Nipple		35120X0	Carbon-PTFE-Liner 2,0x4,0mm / X <sub>m</sub> black
83	2411505	Gun Plug Body with Spring Loaded Pins		35127X0	Carbon-PTFE-Liner 2,7x4,7mm / X <sub>m</sub> black
83.1	2155100	Female Electrical Connector, insulated (PU=20)	101	34120X0K	Kombi-PTFE-Seele 2,0x4,0mm / X <sub>m</sub> rot
83.2	2151501	Liner Positioner Nut		34120X0K	Combi-PTFE-Liner 2,0x4,0mm / X <sub>m</sub> red
84	0040601	Screw M4x6 (1) (PU=20)		34727X0K	Combi-PTFE-Liner 2,7x4,7mm / X <sub>m</sub> yellow
85	2151700	Plug Nut		35120X0K	Combi-Carbon-PTFE-Liner 2,0x4,0mm / X <sub>m</sub> black
			102	34520X1	Steel Liner 2,0x4,5mm / X <sub>m</sub> <sup>1</sup> not insulated
				34525X1	Steel Liner 2,5x4,5mm / X <sub>m</sub> not insulated

*Liners available in 3m/4m/5m. Please insert length at X.  
Example: Steel Liner 4m = 3452041*

<sup>1</sup> Included in standard configuration