



Push-Pull-Manual Welding Torch ARgo PP 550W, water cooled

Technical data according to EN 60 974-7

Rating:

CO ₂ :	500A
Mixed Gas M21:	450A
Duty cycle:	@60%
Wire-Ø:	0,8 – 1,6mm

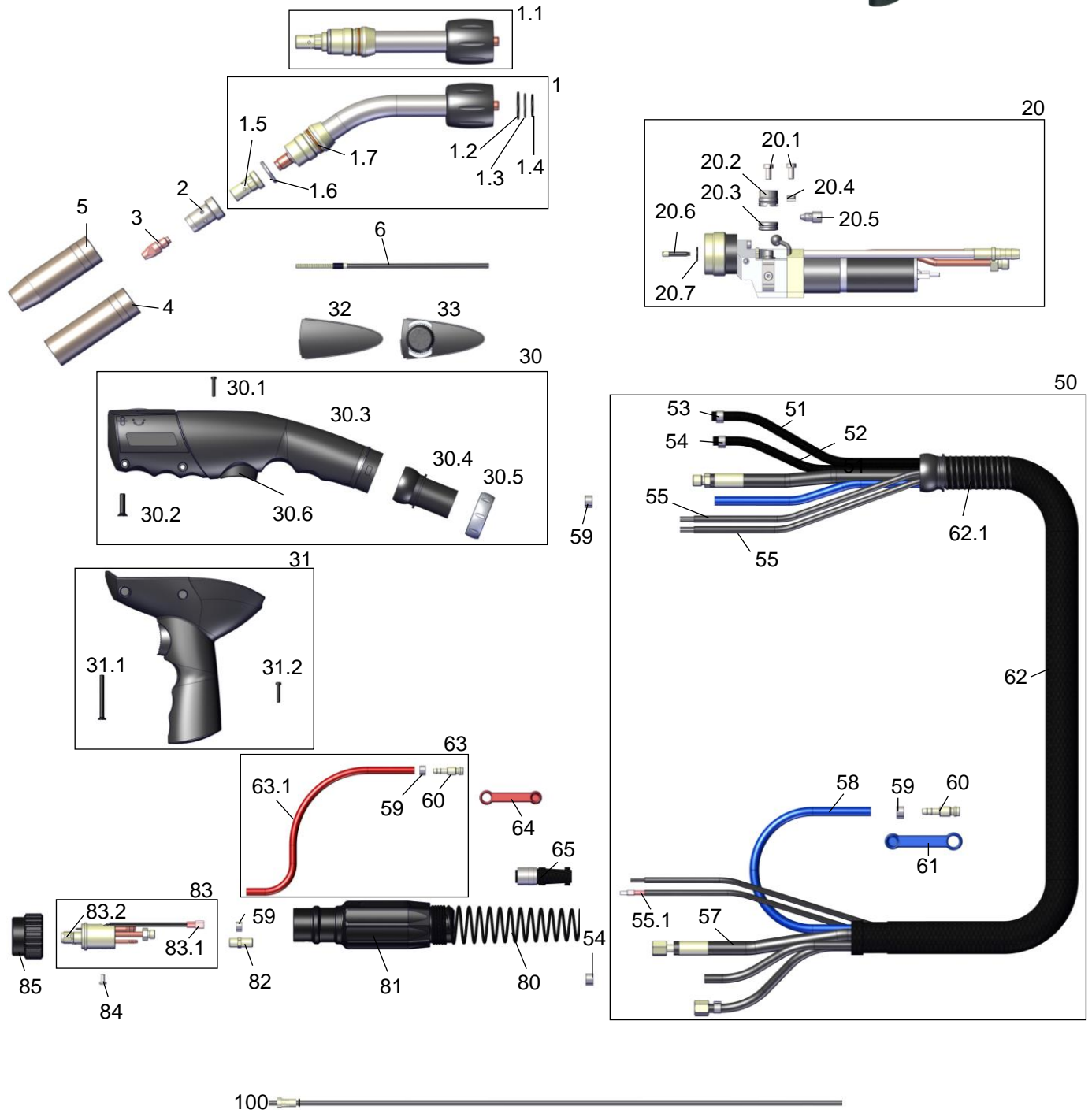

The ARgo PP 550W is a push-pull welding torch in a new, innovative handle design:

- With an additional pistol grip, which you can change by your own (without any intervention in switching contacts or control lines).
- For welding in almost any position with only one torch system – maximum flexibility-!

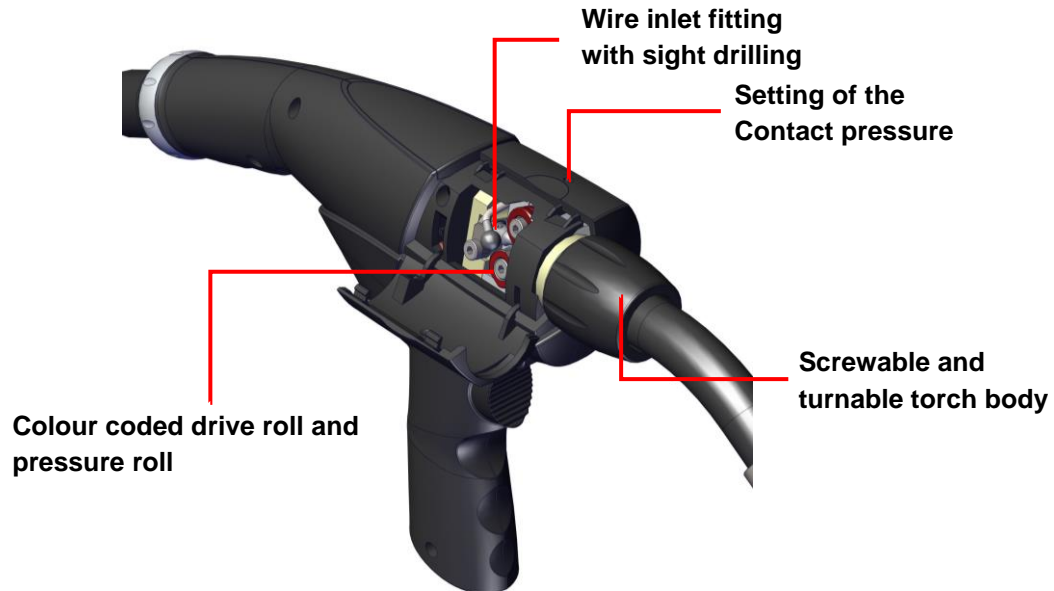

Optional modul for potentiometer



Flexible cable support with ball joint



Change to a pistol grip handle configuration within 1 minute



Part Number for complete Welding Torch
Standard configuration tip Ø 1,2mm Aluminium

	6m	8m	10m
ARgo PP550W cpl., straight neck with pistol grip, euro-connection, Tuchelplug 5 pol. and PA-liner 2,3x4,7mm	7056001	7058001	70510001
ARgo PP550W cpl., 35° neck with pistol grip, euro-connection, Tuchelplug 5 pol. and PA-liner 2,3x4,7mm	7056003	7058003	70510003

Different connections on request

Spare Part List

Pos.	Part No.	Description	Pos.	Part No.	Description
1	2129M100	Neck M-AR 550W-CR 35°	20	714010033	Drive Unit ARgo-PP 550W water, cpl.
1.1	2129M105	Neck M-AR 550W-CR straight	20.1	7080104	Screw M4x8 (PU=20)
1.2	0201500	O-Ring – 20,0x1,5mm (PU=20)	20.2	7082408	Drive Roll Ø 0,8mm Alu
1.3	0181200	O-Ring – 18,0x1,2mm (PU=20)		7082418	Drive Roll Ø 0,8mm Steel
1.4	0161500	O-Ring – 16,0x1,5mm (PU=20)		7082409	Drive Roll Ø 0,9mm Alu
1.5	2410408	Tip Adapter M8 short, Ms ¹ (PU=5)		7082419	Drive Roll Ø 0,9mm Steel
	2410418	Tip Adapter M8 long, Ms (PU=5)		7082410	Drive Roll Ø 1,0mm Alu
1.6	2410203	Isolerring (VE=5)		7082411	Drive Roll Ø 1,0mm Steel
1.7	21201029	O-Ring – 20,0x1,6mm (PU=20)		7082402	Drive Roll Ø 1,2mm Alu
2	2410702	Gas Diffusor, white ¹ (PU=5)		7082412	Drive Roll Ø 1,2mm Steel
	2410700	Gas Diffusor, black (PU=5)		7082404	Drive Roll Ø 1,4mm Alu
	2410702K	Gas Diffusor, ceramic (PU=5)		7082414	Drive Roll Ø 1,4mm Steel
3	24106xx	Contact Tip M 8 x 30, ø in mm/ECu (PU=10)		7082406	Drive Roll Ø 1,6mm Alu
	24176xx	Contact Tip M 8 x 30, ø in mm/CuCrZr (PU=10)		7082416	Drive Roll Ø 1,6mm Steel
	24166xx	Contact Tip M 8 x 30, ø in mm/for Alu ¹ (PU=10)	20.3	7082508	Pressure Roll Ø 0,8mm Alu/ Steel
	<i>Contact Tips available in ø 0.8 / 0.9 / 1.0 / 1.2 / 1.4 / 1.6 mm Please insert wire diameter at xx. Example: ø 1.2 mm is: 12; Part No.: = 2410612</i>			7082509	Pressure Roll Ø 0,9mm Alu/ Steel
4	20016003	Gas Nozzle, cylin. screw. NW21 L=76mm (PU=5)		7082512	Pressure Roll Ø 1,2mm Alu/ Steel
5	200160031	Gas Nozzle, con. screw. ¹ NW16 L=76mm (PU=5)		7082514	Pressure Roll Ø 1,4mm Alu/ Steel
6	7050111	Neck-Liner for bent neck		7082516	Pressure Roll Ø 1,6mm Alu/ Steel
	7050112	Neck-Liner for straight neck	20.4	7080107	Clamp
			20.5	7080120	Guide
			20.6	7080110	Wire Guide
			20.7	0081700	O-Ring – 8,73x1,78mm (PU=20)

¹ Included in standard configuration



Pos.	Part No.	Description	Pos.	Part No.	Description
30	71410201	Handle cpl. (without micro-switch)	59	03211001	Single Ear Clamp D=10,0 (PU=100)
no fig.	2113103	micro-switch	60	2990800	Water Hose Nipple (PU=10)
30.1	00316041	Screw TX M3x16 (PU=20)	61	45050339	Water Stop blue (PU=10)
30.2	0052001	Screw TX M5x20 (PU=20)	62	7104560	Cover Hose Argo-PP cpl. 6m
30.3	714100002	Handle left + right		7104580	Cover Hose Argo-PP cpl. 8m
30.4	45050240	Swivel		7104510	Cover Hose Argo-PP cpl. 10m
30.5	2113102	Ring	63	2414705	Water Outlet Hose cpl. 0,55m
30.6	71410031	Trigger black	63.1	0550108	Water Hose red Ø 5,0x1,5 (PU=100m)
31	7141022	Pistol Grip Handle Attachment	64	45050340	Water Stop red (VE=10)
31.1	0044001	Screw TX M4x40 (PU=20)	65	T3012002	Tuchel-plug 5-pol.
31.2	00316041	Screw TX M3x16 (PU=20)	80	2411611	Cable Support Spring
32	7141002S	Cover black	81	2411600S1	Plug Housing, without nut
33	71410314	Potentiometer-Cover ARgo-PP, 10kOhm	82	2411501	Threaded Nipple
50	7103965	Cable Assembly 6m	83	2411505	Gun Plug Body with Spring Loaded Pins
	7103985	Cable Assembly 8m	83.1	2155100	Female Electrical Connector, insulated (PU=20)
	71039105	Cable Assembly 10m	83.2	2151501	Liner Positioner Nut
51	7104660	Outer Liner 6m cpl.	84	0040601	Screw (PU=20)
	7104680	Outer Liner 8m cpl.	85	2151700	Plug Nut
	7104610	Outer Liner 10m cpl.	no fig.	7103964	Cable Assembly 6m, cpl. with Euro-connection
52	0550112	Gas Hose Ø3,0x1,5 (PU=100m)	no fig.	7103984	Cable Assembly 8m, cpl. with Euro-connection
53	03211281	Single Ear Clamp D=12,8 (PU=100)	no fig.	71039104	Cable Assembly 10m, cpl. with Euro-connection
54	03210751	Single Ear Clamp D=7,5 (PU=100)	100	34120X0	PTFE-Liner 2,0x4,0mm / X _m red
55	92250050	Control cable 2x0,5mm ² (PU=100m)		34727X0	PTFE-Liner 2,7x4,7mm / X _m yellow
55.1	2155200	Male Electrical Connector, insulated (PU=20)		35120X0	Kohle-PTFE-Liner 2,0x4,0mm / X _m black
57	7104160	Power Cable cpl. 6m		35127X0	Kohle-PTFE-Liner 2,7x4,7mm / X _m black
	7104180	Power Cable cpl. 8m		35220X0	PA-Liner 2,0x4,0mm / X _m anthracite
	7104110	Power Cable cpl. 10m		35323X0	PA-Liner 2,3x4,7mm / X _m ¹ anthracite
58	0550105	Water Hose blue Ø 5,0x1,5, (PU=100m)		35327X0	PA-Liner 2,7x4,7mm / X _m anthracite

*Liner available in 6m/8m/10m. Please insert length at X.
! Attention: Liner with 10m length, please insert 1!
Example: PTFE-Liner 8m = 3412080*

¹ Included in standard configuration